

Eliminates Fines, Streamers and Tubing Wear from Resin Conveying

In resin conveying, conventional radius elbows are designed to “soften” the turn resin must take when changing direction. But traditional long or short radius bends, create undesirable friction from the high speed resin, creating heat, abrasion of the resin and the elbow, streamers and dust.

Available in stainless steel or aluminum, a Pellbow installed in place of conventional bends eliminates resin riding against the inside wall of a radius elbow. The results are a dramatic decrease in heat, dust, streamers and virtually no wearing of the elbow. By design, material flowing through the Pellbow accumulates in the pocket of the “impact zone” and moves gently upward and then out of the elbow. Material has no damage from impact.



Compact, Self-Cleaning Pocket Elbow Guides Resin Across Resin

Resin conveying is an efficient, high speed process that moves pellets quickly to their destination. But conveying can be self-destructive when the resin being moved is abrasive and damaging to bends that must direct fast-moving resin in another direction. Elbows can quickly wear, from the inside out, resulting in lost resin, lost production, downtime and costly elbow replacement. Soft material conveying often results in the formation of streamers and dust from the same elbows.

Pellbows solve these issues and many more by providing a smooth, compact pocket for temporary resin collection. Once filled with resin, the accumulation provides an efficient redirection of resin around the bend with no abrasive contact with the metal bend. This dynamic resin to resin contact creates no heat, and as a result, no resin abrasion, no streamers and no dust.

And unlike competitive models, Pellbows rapidly and totally evacuate resin during purge cycles, permitting the use of multiple resins without contamination.

▶ Easily replaces traditional elbows

Pellbows are offered in a wide range of tubing diameters to match your system needs perfectly. All sizes are available in aluminum and stainless steel. Selected sizes are available in cast ductile iron. For heavy duty applications, abrasive resistant alloy versions and coatings are available upon request.

▶ Minimal pressure drop, reduced noise level

Long radius sweeps are not required to keep your resin moving. The smooth operation of Pellbows allows them to replace any radius sweep with minimal change to conveying.

▶ Self-cleaning, compact and easy to install

Pellbows are measurably more compact than any elbow they will replace. Tubing can be routed far easier with no need to accommodate cumbersome bends.

▶ Convey and purge with confidence

Resin is efficiently conveyed through the Pellbow pocket and is also efficiently purged in systems equipped with line purging capability.

▶ Choose aluminum or stainless steel

Choose aluminum construction for soft materials like PE, or stainless steel for harder, more abrasive resins.



How it Works

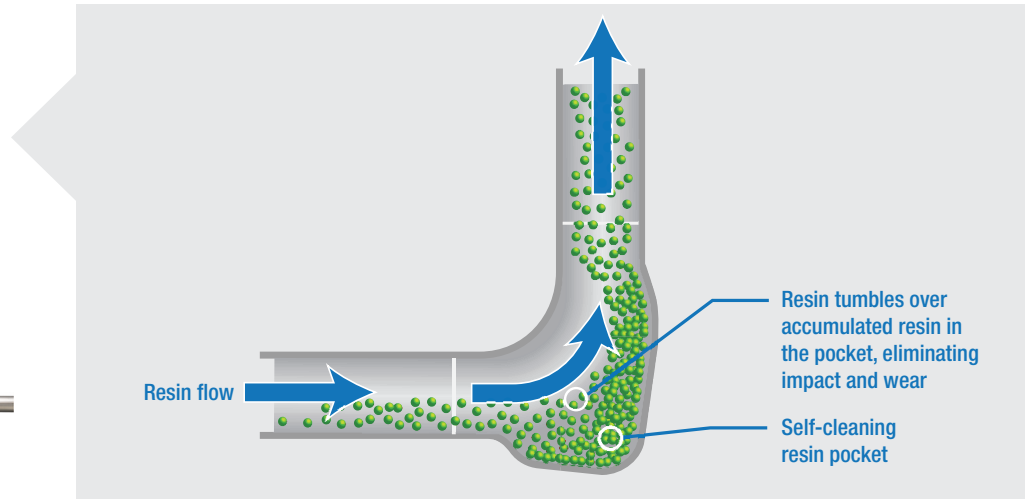
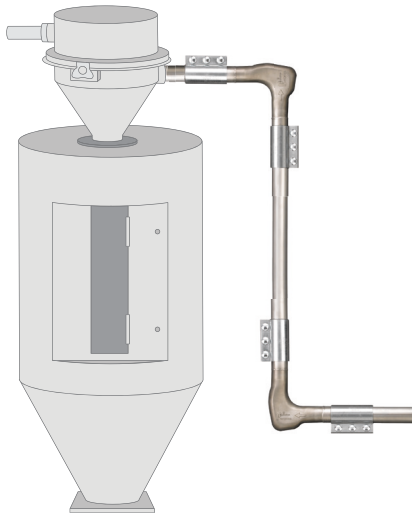

Application Notes

Pellbows also available in cast iron and with flanged inlets and outlets.

For all applications, material-to-air ratio must be a minimum of 3:1.

Contact the factory for pricing and information.

All your conveying system needs

Conair supplies the widest range of conveying components for complete plant-wide installations or single components. Call Conair for:

- Tubing
- Bends
- Couplers
- Flex hose
- Material shut-off valves
- Material purge valves
- Feed tubes
- Take-off (distribution) boxes
- Complete resin conveying systems

Specifications

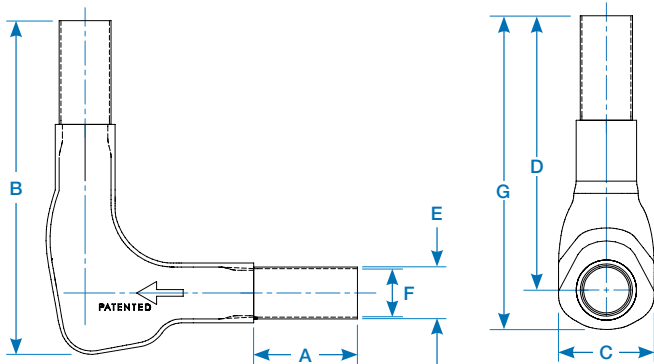

Application guide			
Pellbow construction	Aluminum	Stainless steel	Stainless steel with abrasion resistance treatment
Material			
HDPE, LDPE, PP, PS	●		
PET, PC, PVC, Acrylic		●	
Any glass filled (up to 10%)		●	
Any mineral filled (up to 10%)		●	
Any glass filled (over 10%)			●
Any mineral filled (over 10%)			●

For all applications, material-to-air ratio must be a minimum of 3:1.

Models (tube OD in.)	1.5	2.0	2.5	3.0	4.0	5.0		
Tube gauge	16	16	16	16	16	11	14	11
Part number								
Aluminum	N/A	26725703	26725705	26725707	26725710	26725711	26725714	26725715
Stainless steel	26725701	26725702	26725704	26725706	26725708	26725709	26725712	26725713
Stainless steel abrasion resistant	2672570101	2672570201	2672570401	2672570601	2672570801	2672570901	2672571201	2672571301
Dimensions inches {mm}								
A - Tube length	4.00 {100}	4.00 {100}	4.00 {100}	4.00 {100}	4.00 {100}	6.00 {150}		
B - Overall length	11.91 {302}	12.87 {327}	13.96 {356}	15.39 {391}	17.67 {449}	21.45 {545}		
C - Body width	2.80 {71}	3.66 {93}	4.62 {117}	5.55 {141}	7.14 {181}	8.43 {214}		
D - From CL	10.00 {254}	10.50 {267}	11.00 {279}	11.75 {298}	13.00 {330}	16.00 {406}		
E - Tube OD	1.50 {40}	2.00 {50}	2.50 {65}	3.00 {75}	4.00 {100}	5.00 {125}		
F - Tube ID	1.37 {35}	1.87 {47}	2.37 {60}	2.87 {73}	3.87 {98} 3.76 {96}	4.83 {123} 4.76 {197}		
G - Overall length	11.22 {285}	12.01 {305}	12.98 {330}	14.04 {357}	15.94 {405}	19.53 {497}		
Approximate installed weight lb {kg}								
Stainless steel	5 {2}	7 {3}	9 {4}	15 {7}	31 {14}	44 {20}		
Aluminum	N/A		3 {1}	6 {3}	12 {5}	18 {8}		

Specification Notes
 Specifications may change without notice. Consult a Conair representative for the most current information.

